

ESQUIRE

*A Product from your friend*

## COMPANY PROFILE



Esquire IVF Equipments Private Limited is a research and instrumentation company for Assisted Reproductive Technology(ART).

15 years of Experience in the field of IVF

We are expertise with a conscious thrust on improving the value delivered to our customers.

We have been successfully executing technology-enabled instrumentation and cleanroom solutions for the IVF industry.



**SRIRAM**  
Managing Director

- Having 20 years of experience in the field of ART,
- Designed unique and customized products
- Started his carrier as a service engg & started esquire in 2002
- More than 100+ ART Setup in all over south India.

## WHAT WE DO?



- Project report preparation with feasibility studies
- Site survey by experts which includes architects, clinicians & embryologist
- Lab design and execution for modular projects
- Implement sterile cleanroom environment.
- Arrange Training for Clinicians and embryologist in India as well as abroad
- Equipment selection and supply
- Installation and equipment's handling training on site
- Supply of disposables
- Quality control check for VOC, pH, Humidity, Temperature, Hygiene of surface/water, particle count of all HEPA ltration system
- Assistance on recruitment or freelance of embryologist and guiding technicians how to maintain IVF lab.

**ESQUIRE**  
*A Product from your friend*

# 8 Steps to Creating Effective IVF lab

Creating IVF lab is the process of making choice by identifying a decision and gathering information.

Using a step-by-step creating IVF lab process can help you make more deliberate, thoughtful decision by organising relevant information. This approach increases the chances that you will choose the most satisfying IVF LAB creation.



ESQUIRE

*A Product from your friend*

### LAF 2 FEET

- Made of GI with powder coat finish
- Working Table S.S. 304
- Working area : 650 L x 600 W x 600 H in mm .
- Vertical down flow laminar system
- HEPA filters with rating of 99.99% efficiency 0.3 $\mu$  particulate
- EBM german blower for continues operation.
- Illumination light & germicidal UV Incorporated
- Additional power point inside the working area

ESQUIRE



### IUI WORKSTATION

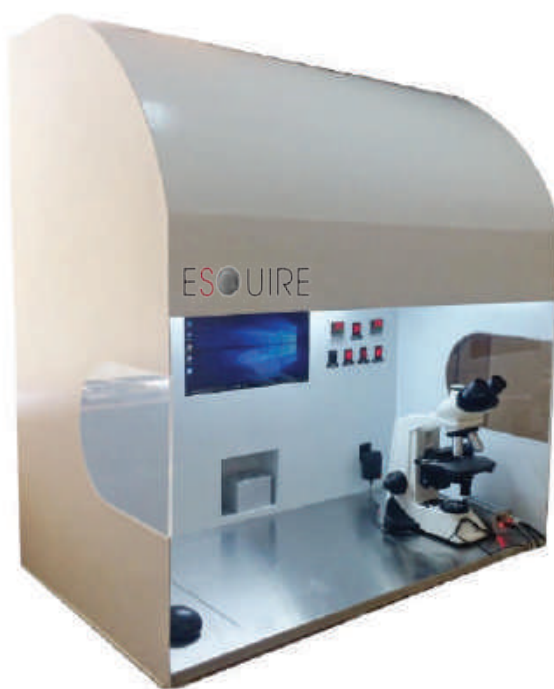

- Star IUI workstation designed for semen analysis, processing & Morphology.
- Heating coils composed in aluminium for optimum temperature accuracy
- 2 independent heating systems ( table & block )
- Low Noise level 56dBA
- HEPA Filtration : 0.3 micron Classification
- Built in system for analysis,IUI & freezing.
- A test tube warmer, built in the back wall.

*A Product From Your Friend*

## CENTRIFUGE



- Make: Remi
- Model: R8M plus
- Brushless induction Motor
- LCD Display of speed & time
- Imbalance detector
- Safety lid lock
- 8\*15ml swing out rotor head.

## OLYMPUS

- Make : OLYMPUS
- Model : MLX-TR PLUS
- Complete set with built-in 6v 20w
- Halogen light illuminator,
- Objectives 4x, 10x, 20x, 40x (spring) and 100x
- Inclined trinocular observation tube  
Rotatable through 360 degree fitted  
With fungus resistant,
- Anti-reflection coated prism,



## SPERM COUNTING CHAMBER

- Sperm count performed from undiluted specimen.
- No additional factors are necessary for calculation.
- The depth of 10 microns eliminates blurring and allows sperm to move freely  
The grid is in the cover glass.
- Reusable
- Observation of color fringes at the four contact points
- provides a test for accuracy.
- Repeated use with complete accuracy without calibration
- Manufactured by state of the art precision engineering



*A Product From Your Friend*



## DRY INCUBATOR

- Body made of GI with powder coat finish
- Chamber made of SS304
  - Omron PID controller for better accuracy
  - Two shelves for storage your disposable and semen samples
  - Temperature range from 49.9°C
  - Temperature accuracy :  $\pm 0.3^{\circ}\text{C}$
  - Compact design
  - Chamber size 420 x 420 x 400mm
  - Visible polycarbonate front door to view disposable and samples



## HEATING BLOCK



- Model: MS / SS Heating Block
- Made of GI with powder coat finish / Made of SS Body
- Omron PID Controller
- Temperature accuracy  $\pm 0.2^{\circ}\text{C}$
- Temperature range ambient to 49.9°C
- 3 No's of anodised aluminium blocks
- Each blocks can hold 6 No's of ASP tubes
- Optimal 30° angle block
- Easy to clean block

*A Product From Your Friend*

## ASPIRATION PUMP



- Make : Craft
- Model : Rocket
- Constant flow rate during aspiration
- The aspiration unit has a rapid response at the needle tip when foot pedal is activated Ultra-quiet, vibration free operation
- Foot pedal allows hands free operation

## TROLLEY



- Mobile trolley for oocyte retrieval
- Heated smooth tabletop & heated drawer
- Shelf for storage
- Adjustable temperature with key
- Inbuilt Heating Block

*A Product From Your Friend*

Esquire IVF Workstation is designed with optimized environment for Oocytes & Embryo's

Esquire IVF Workstation can be **customized** as per Embryologist choice

### 4 Different Models

Basic – 4 feet

Spacious – 5 feet

Dual – 6 feet

ICSI – 6 feet

### Monitoring System

Monitor is flushed in the back wall of the working area for an easy view & detailed oocyte identification & grading

### Heated Table Working Area

- Aluminium Composed Silicone Heating Technology
- Silicone with stands all environmental conditions across the globe
- A patterned Silicone heating system is composed in aluminium for a better Accuracy & Uniformity

### Built in Glass Stage

- Circular or Rectangular ITO based glass stage in the light opening
- 2.5 mm thick glass stage for long durability
- BK 7 grade glass with transparency accuracy 85%

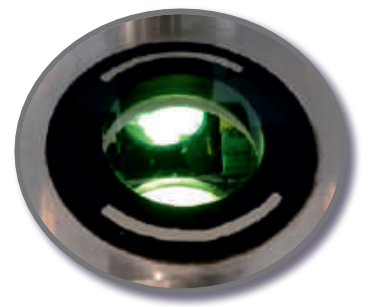

*A Product From Your Friend*





### Microscope Mounting

- Any brand stereo microscope can be mounted on the table
- Microscope is mounted in such a way that the eye piece projects outside the workstation to validate contamination protocol

### LED Light Source Transmitted

- LED light source with bi-directional & frosted mirror to focus the light intensity precisely.
- In-built LED yellow/ grey light source for easy embryo access



### Miniature Test Tube Warmer

- Built-in miniature test tube warmer movable to the whole working area of the workstation to facilitate the oocyte identification

*A Product From Your Friend*

AHU TOWER

AIR PURIFICATION SYSTEM



- 4 Stages of filtration
- Optional UVC Germicidal
- Removes VOC & CAC effectively
- Noiseless design ( less than 56dBA )
- Standby / Run Mode
- Effectively covers area up to 200 sgft
- Continuous operation runs 24hrs 365days
- 70% recirculation 30% fresh air



Stage 1 -  
10 $\mu$  filter – dust & bigger



Stage 2 -  
V blank carbon filter -  
Molecular Contaminant  
Removal – VOC/CAC



Stage 3 -  
5 $\mu$  filter – carbon &  
bigger than 5 $\mu$



Stage 4-  
HEPA – 0.3 $\mu$ filter –  
particulates – 99.97%

*A Product From Your Friend*

## TOWER RECIRCULATION

- Improved Air Quality = Higher Fertilization Rates
- 100 % Air recirculation in IVF lab
- Carbon filter will remove VOC & CAC free  
Class 10,000 environment
- HEPA filters will remove 0.3 micron particles
- Pre Filter will remove 10 and 5 micron particles
- Blowers(2 Nos) with Noise level <52dBA
- Standby & running mode.
- Magnehelic gauge will represent filter life time
- Easy movable with wheels
- Covers upto 200 Sq.Ft area
- Optional : Germicidal UVC



## MOBILE AIR



- Movable to required area
- Activated Carbon impregnated with alumina & KOH removes molecular contaminants
- HEPA filtration removes particulate contaminants
- 4 speed option for variable room size.
- 51 dBA Low noise level
- Maximum Air Flow: 300 Cubic Feet/minute
- Air Exchanges/Hour i 150 sq. ft.: 9.53
- Effective Coverage: 150 sq. ft.
- 100% recirculation

*A Product From Your Friend*

## ANTI-VIBRATION TABLE



Designed and developed to meet the requirement of ICSI procedure

Eliminating vibrations and ensuring a fast dampening effect is essential when working with inverted microscope

- Model: MS powder coated AVT/SS AVT
- The Anti-Vibration handles from light to heavy inverted microscope
- MS powder coated AVT top with stainless steel platform / In SS AVT top is frosted toughened glass platform
- The damping systems use column-friction for optimal result
- The damping systems use column-friction for optimal result
- An equilibrated and isolated platform for the inverted microscope
- Working range 15-75kg
- Roomy workspace around the micro manipulating systems
- Space for mini incubator
- MS powder coated shelf for accessories / SS shelf for accessories.
- Dimension:  
1200 L x 700 W x 705 H in mm

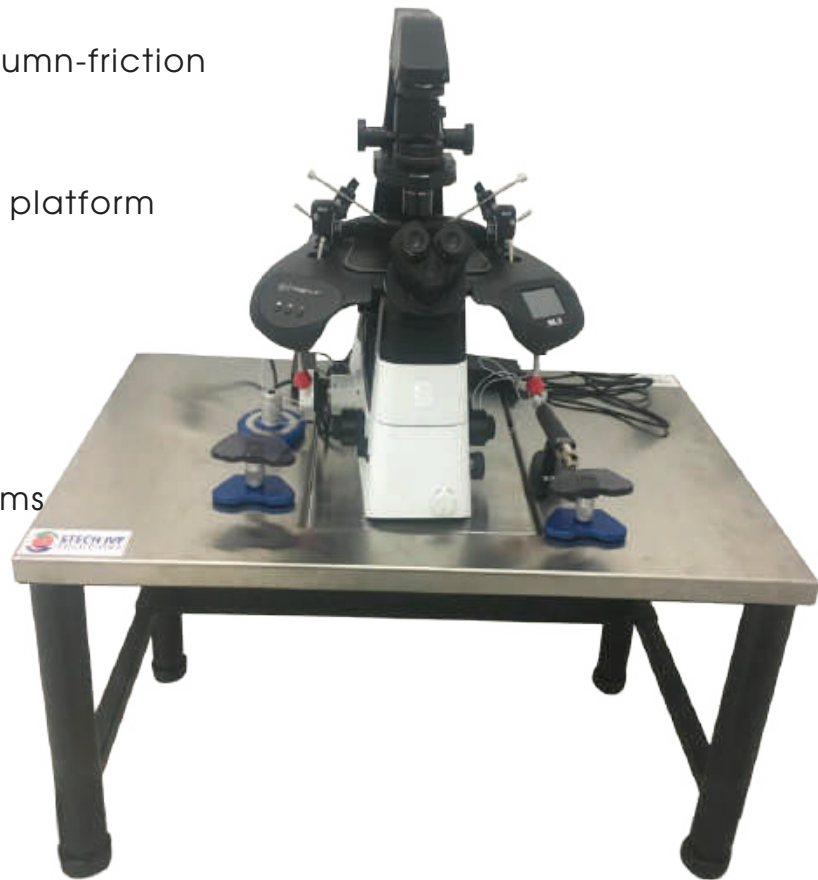

*A Product From Your Friend*

# BINDER CO<sub>2</sub> INCUBATOR



- Temperature range: ambient temperature plus 4 °C to 60 °C
- Humidity range: 90 to 95% RH
- CO<sub>2</sub> control range: 0 to 20 vol% CO<sub>2</sub>
- O<sub>2</sub> control range: 0.2 to 20 vol% O<sub>2</sub> for versions with O<sub>2</sub> control
- Alternative O<sub>2</sub> control range: 10 to 95 vol% O<sub>2</sub>, option for versions with O<sub>2</sub> control
- Auto-sterilization with hot air at 180 °C
- Lockable door handle
- Tightly-sealed inner door made of tempered safety glass
- Seamless, deep-drawn inner stainless steel chamber
- 2 perforated stainless steel shelves
- Units are stackable with stacking adapter
- Computer interface: Ethernet
- Zero-voltage alarm contact
- 6 Divided inner door

*A Product From Your Friend*



## OLYMPUS-IX73

Olympus IX73 inverted microscope system with Narishige ON4 micromanipulator.



- Speedy switching of the observation methods can be done by a simple button hand-switch exclusive to ICSI operation.
- Olympus' relief-contrast allows the observation of 3-dimensional oocytes in plastic dish
- Eliminating light intensity adjustments when switching objectives.
- Front Operation of Condenser Height - Possible to operate without worrying about manipulator.
- Magnification Changer - Easy to change magnification without changing the objective (possible magnifications: 1x, 1.6x or 2x).

## NARISHIGE-ON4

### Newly designed dedicated adapter

The junction positions of the microscope's support section and the supporting parts of the motor-driven manipulator are set depending on each pipette's angle, and the angle of the pipette holder can be easily adjusted.

### Improved stability

The set location of the pipette holder is positioned on the central shaft of the universal joint. It improves the stability of the pipette holder in combination with the novel mechanism.

The enlarged angle indicator and newly added angle index on the universal joint improve the readability of the pipette angle display.

In addition, pipettes can be manually moved up and down using the dial with an arrow displayed

### Improved operability

Operability is improved with reduced rebound risk and enhanced responsiveness.

### Oil-type Microinjector IM-9B

The IM-9B is suitable for injection and provides smoother and more stable manoeuvrability by employing a mechanism that minimizes backlash.

### IM-9CPneumatic injector

Crisp response with air pressure.



*A Product From Your Friend*

## VOC METER

- Real time indoor air quality and alarm
- 0 – 20ppm Qualitative VOC measurements
- Temperature and humidity detection and display
- Three-color backlit LCD and Buzzer alarm
- High quality technics elegant appearance & CE-approval



## THERMOMETER



- Make : Omega
- Dual K type micro droplet thermocouple
- Thermocouple offset Adjustment
- Data Storage for 120 Samples
- Protective Rubber cover
- Auto-Range: 0.1/1° Resolution

*A Product From Your Friend*

EnviSafe iv designed for optimal user and sample protection. It is prepared for a stereo microscope for observation under a cabinet. It comes with built-in heated stage under the microscope to provide optimal working condition.



#### FEATURES

- Table top is made of stainless steel integrated with 2-sides heating areas to give an optimal working condition
- High resolution touch-screen display
- Mounting assembly for most stereo microscopes integrated with large strengthend heated glass
- Multiple protection design increases Security level significantly
- Innovative surrounded air intake grill design
- ECM brushless DC motor with good energy efficiency
- Supply/Exhaust HEPA filter 99.99% efficiency @ 0.3micron (Class H14)
- 254 nm UV lamp with 6mm anti-ultraviolet tempered glass
- 1,000 Lux fluorescent lamp
- Ergonomic 10 degree angle



TOUCH-SCREEN DISPLAY



LARGE STRENGTHEND HEATED GLASS

*A Product From Your Friend*

## IncuWork *ie*

IncuWork is an IVF Working chamber, totally closed embryo culture system, which substantially enhances the working environment for IVF procedures.

### SPECIFICATIONS

#### External workstation dimensions

- Height (excluding stand): 725 mm
- Width (side to side): 1180 mm
- Depth: 690 mm

#### Internal workstation dimensions

- Height: 590 mm
- Width: 1174 mm
- Depth: 570 mm

#### Hatch box interlock dimension

- Height: 220 mm
- Width: 220 mm
- Depth: 320 mm

#### Atmosphere Control

- Temperature: ambient 5°C- 45°C
- O2 Control: 0 - 10%
- CO2 Control: 0 - 10%

#### Alarms

- Temperature: visual and audible
- Gas level: visual and audible

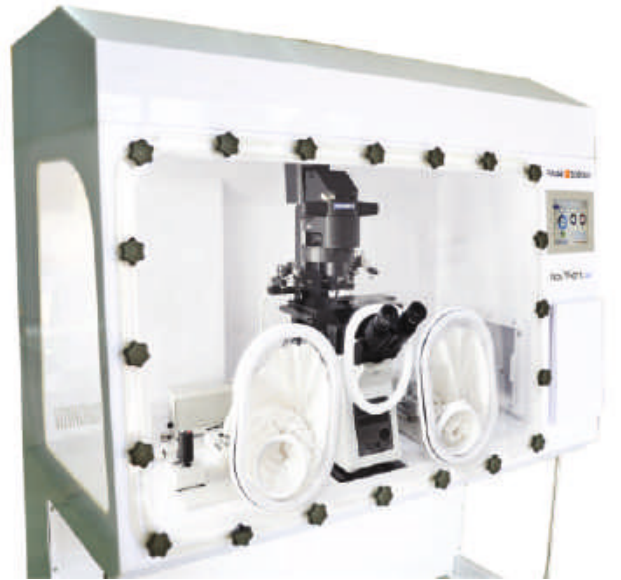

TOUCH-SCREEN DISPLAY

The IncuWork *ie* is designed for efficiency and comfort allowing the operation to reduce stress and fatigue. Easy and comfortable performance.

This product can reduce embryo stress, improve embryo implantation rates, improve egg quality and increase the clinical pregnancy rates.

*Ergonomic design*

*Stable O2, CO2, temperature and humidity*



*A Product From Your Friend*

# VitStation

VitStation is the first all in one workstation for cryopreservation and thawing process to ensure optimal continuous working condition. By using this new all in one workstation we can save laboratory space and make everyday life easier for the operator. The VitStation can increase probability of sample vitrifying success and reduce cells damage due to ice crystallization



## FEATURES

- Extreme freeze at -210 °C
- Stainless steel table top
- Integrated heated surface with 2 heating areas
- Combining freezing, heating and observation areas
- Mounting assembly for stereo microscopes
- Individual control for each heated areas
- Integrated verification chamber at freezing area
- One touch button for pressure releasing



## SPECIFICATIONS

Over all	120 cm (W) x 87 cm (H) x 65 cm (D)
Working area	120 cm (W) x 80 cm (H) x 50 cm (D)
Each of heating area dimension	20 cm (W) x 30 cm (H)
Vacuum chamber	36.5 cm (W) x 12.6 cm (H) x 17.5 cm (D)
Temperature controller	PID
Power	220 VAC (EMI Filter socket)
Heat plate Silicone heater	Silicone heater

*A Product From Your Friend*



## Tabletop Multi-Chamber Incubator



### Features

1. Excellent efficiency with 8 chambers
2. Heating lid/bottom of each chamber offers the best temperature environment
3. Individual gas management ensures minimum gas waste
3. User-friendly Graphical User Interface
4. All Log Data will be maintained and ready for download
5. Comfortable LCD Touch Monitor
6. Temperature Calibration, Alarm List, VOC Filter Management



*A Product From Your Friend*

Synvivo



## Eight Chambers are all independently controlled



- ✓ Each chamber's incubation on/off and setting
- ✓ Each chamber's lapsed duration of incubating
- ✓ Each chamber's set and ongoing temperatures
- ✓ Icon for setting configuration
- ✓ Icon for temperature control
- ✓ List of triggered alarms
- ✓ GAS supply pressure
- ✓ VOC Filter expiration



*A Product From Your Friend*

TABLE TOP INCUBATOR

i-EM900



## Time-Lapse Embryo Monitoring System

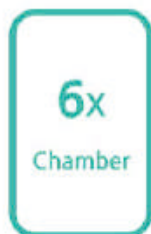

*A Product From Your Friend*

EMBRYO MONITORING SYSTEM



## IVF Consultation and Lab design

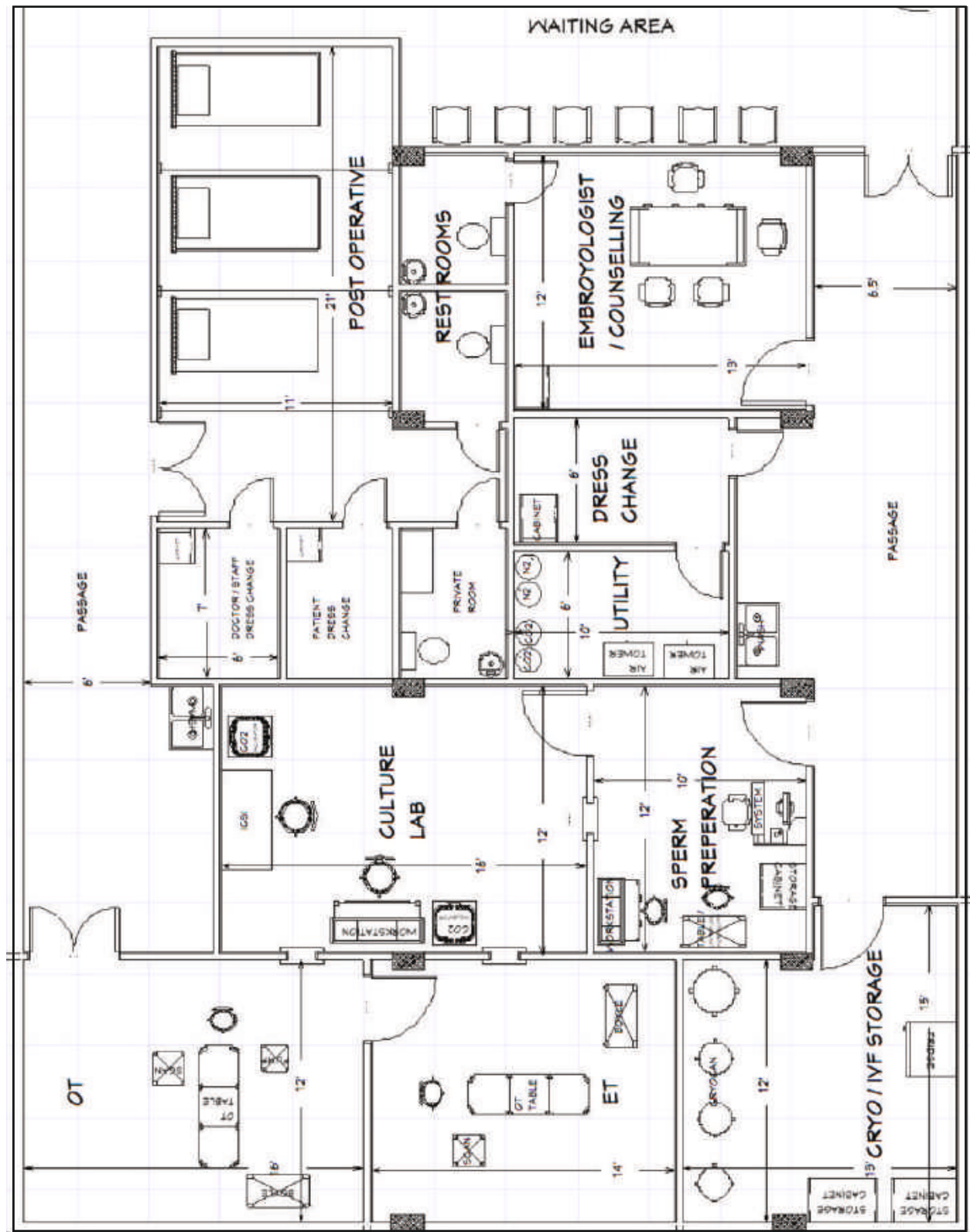

DESIGNED BY: ESQUIRE IVF EQUIPMENTS PRIVATE LIMITED

### Notes:

This image shows a full page of white paper with horizontal dashed red lines. The lines are evenly spaced and run across the width of the page, providing a guide for handwriting practice. There are no margins, text, or other markings on the paper.





*A Product from your friend*

**Contact Us**

**ESQUIRE IVF EQUIPMENTS PRIVATE LIMITED**

**#5A, Sri Mahalakshmi Co-Operative Nagar, Vazhuthalampedu,  
Kundrathur Chennai 600 069**

**[www.esquires.in](http://www.esquires.in)**

**Contact Details**

**[sriram@esquires.in](mailto:sriram@esquires.in) || [admin@esquires.in](mailto:admin@esquires.in)  
70105 80749 || 73977 40883**